

WHEEL ASSEMBLY
SCALE 1 : 1

PARTS LIST				
ITEM	QTY	PART NUMBER	MATERIAL	DESCRIPTION
1	1	AXEL	STEEL	
2	1	BUSHING	BRONZE	OILLESS
3	1	HUB	ALUMINUM	
4	1	COLLAR	ALUMINUM	
5	2	PANEL RING	ALUMINUM	1.2" UNIFORM THICKNESS
6	1	WHEEL	HARD RUBBER	
7	6	RIVETS	STANDARD	∅.31, 1.00" INSIDE LENGTH, EQUALLY SPACED (97300A709)
8	2	WASHERS	STANDARD	I.D. 1.00", O.D 2.12", .18" THICK
9	1	SPRING PIN	STANDARD	∅.25, 1.875" LONG (MCMASTER-CARR 98296A932)

DIGITAL DESIGN
GRAPHICS
TECHNOLOGY

WWW.DDGTNET.NET

GENERAL NOTES:
ALL FILLETS HAVE R.125"
UNLESS OTHERWISE
NOTED
ALL CHAMFERS ARE .06"
X 45" UNLESS
OTHERWISE STATED

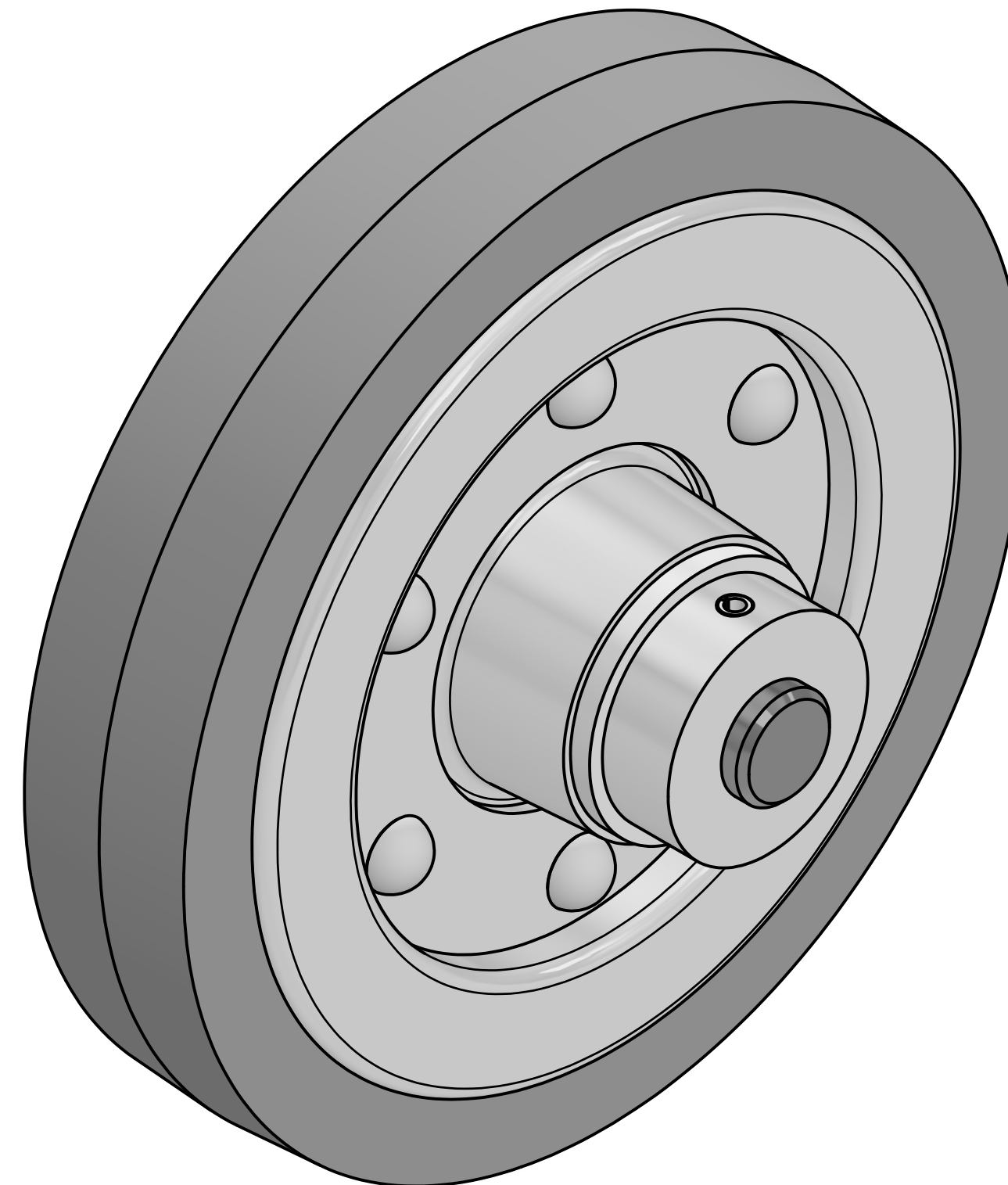

WHEEL ASSEMBLY
SCALE 1 : 1

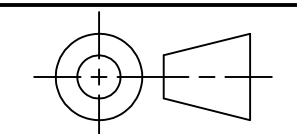

TOLERANCES UNLESS SPECIFIED
DECIMAL INCHES:
X = ±.020
XX = ±.010
XXX = ±.005
FRACTIONAL ±1/64"
ANGLES ±1 DEGREE

SURFACES $\sqrt{\text{V}}$

CLASS: DDGT 121

ASSIGNMENT #: 11

INVENTOR DRAWING NAME:

WHEEL ASSEMBLY

FIG #: 11-55

MANAGER: G. STROMMEN

DRAFTER: J. GALLAGHER

DATE: 4/11/2026

SCALE: AS NOTED

PAGE #: 1 OF 3

LEGEND:

∅ DIAMETER
R RADIUS
° DEGREES

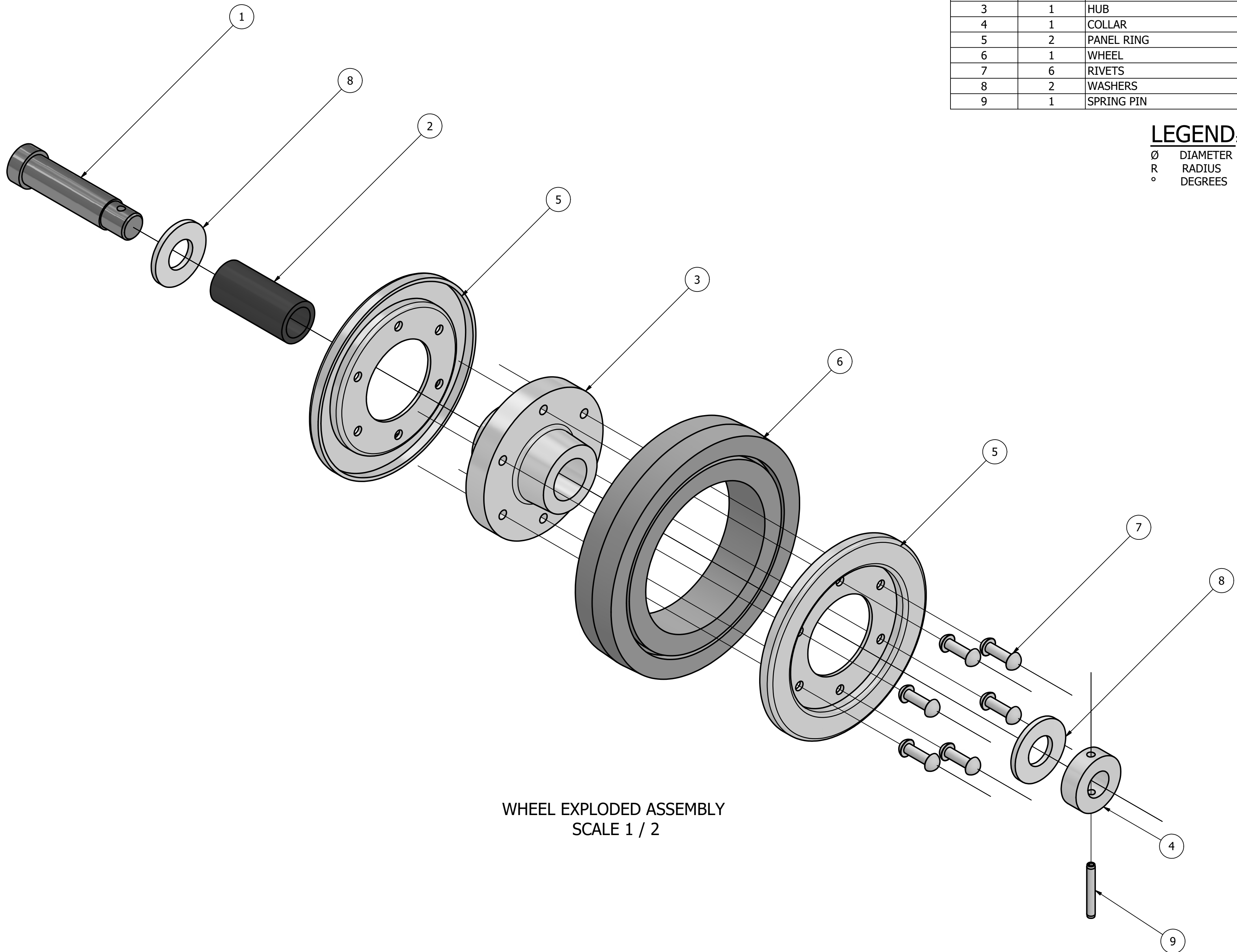

PARTS LIST		
ITEM	QTY	PART NUMBER
1	1	AXEL
2	1	BUSHING
3	1	HUB
4	1	COLLAR
5	2	PANEL RING
6	1	WHEEL
7	6	RIVETS
8	2	WASHERS
9	1	SPRING PIN

LEGEND:
 Ø DIAMETER
 R RADIUS
 ° DEGREES

DIGITAL DESIGN
 GRAPHICS
 TECHNOLOGY

WWW.DDGTNET.NET

GENERAL NOTES:
 ALL FILLETS HAVE R.125"
 UNLESS OTHERWISE
 NOTED
 ALL CHAMFERS ARE .06"
 X 45" UNLESS
 OTHERWISE STATED

WHEEL EXPLODED ASSEMBLY
 SCALE 1 / 2

TOLERANCES UNLESS SPECIFIED
 DECIMAL INCHES:
 X = ±.020
 XX = ±.010
 XXX = ±.005
 FRACTIONAL ±1/64"
 ANGLES ±1 DEGREE

SURFACES $\sqrt{\quad}$

CLASS:	DDGT 121
ASSIGNMENT #:	11
INVENTOR DRAWING NAME:	WHEEL ASSEMBLY
FIG #:	11-55
MANAGER:	G. STROMMEN
DRAFTER:	J. GALLAGHER
DATE:	4/11/2026
SCALE:	AS NOTED
PAGE #:	2 OF 3

PARTS LIST		
ITEM	QTY	PART NUMBER
1	1	AXEL
2	1	BUSHING
3	1	HUB
4	1	COLLAR
5	2	PANEL RING
6	1	WHEEL
7	6	RIVETS
8	2	WASHERS
9	1	SPRING PIN

DIGITAL DESIGN
GRAPHICS
TECHNOLOGY
WWW.DDGTNET.NET

GENERAL NOTES:
ALL FILLETS HAVE R.125"
UNLESS OTHERWISE
NOTED
ALL CHAMFERS ARE .06"
X 45" UNLESS
OTHERWISE STATED

LEGEND:
Ø DIAMETER
R RADIUS
° DEGREES

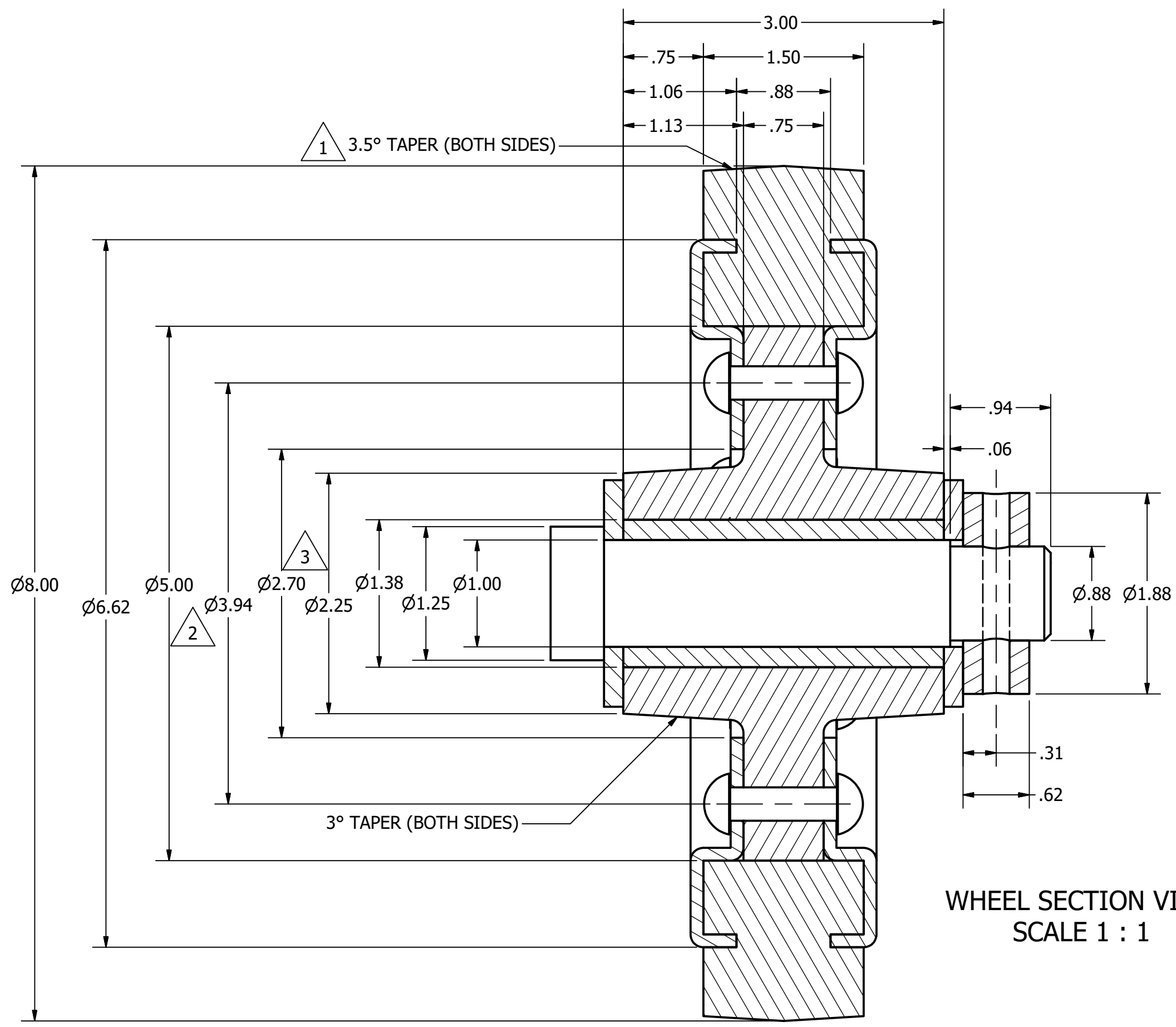

WHEEL SECTION VIEW
SCALE 1 : 1

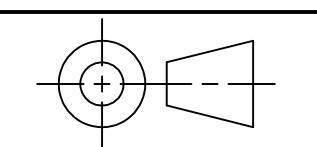

TOLERANCES UNLESS SPECIFIED
DECIMAL INCHES:
X = ±.020
XX = ±.010
XXX = ±.005
FRACTIONAL ±1/64"
ANGLES ±1 DEGREE
SURFACES 32

CLASS: DDGT 121

ASSIGNMENT #: 11

INVENTOR DRAWING NAME:
WHEEL ASSEMBLY

FIG #: 11-55

MANAGER: G. STROMMEN

DRAFTER: J. GALLAGHER

DATE: 4/11/2026

SCALE: AS NOTED

PAGE #: 3 OF 3

REV	DATE	DESCRIPTION	APPROVED	SHEET
3	4/12/2026	INSIDE DIAMETER OF PANEL RING CHANGED FROM Ø2.80" TO Ø2.70"	G. STROMMEN	3
2	4/12/2026	CENTERLINE DIAMETER FOR RIVET PATTERN CHANGED FROM Ø3.50 TO Ø3.94	G. STROMMEN	3
1	4/12/2026	TAPER ANGLE ON WHEEL CHANGED FROM 5° TO 3.5°	G. STROMMEN	3
REV	DATE	DESCRIPTION	APPROVED	SHEET

REVISION HISTORY